

- STANDARD HINGE FOR WINDOWS AND DOORS WITH EUROPEAN GROOVE.
- PREASSEMBLED FLANGES, ASSEMBLED SHAFT AND SLEEVES. (LEFT OR RIGHT ASSEMBLY)
- CENTRAL SCREW TO AVOID SLIDING.
- MAXIMUM DIMENSIONS: 1000 X 2000 mm.
- MAXIMUM LOAD OF 60Kg.
- LATERAL SETTING OF +/- 1mm. THANKS TO THE ECCENTRIC SLEEVE. (OPTION)
- MAXIMUM RESISTANCE TO CORROSION.
- ADAPTABLE TO FIXED FRAMES 14X18/13X16,5/12X15/10X14

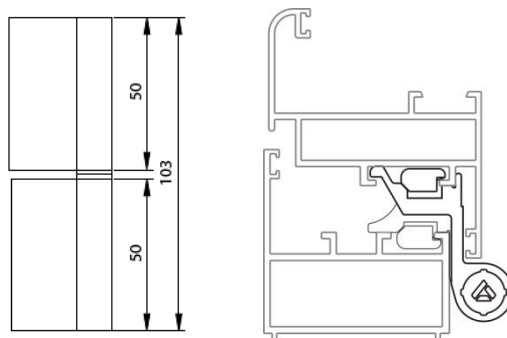

DIMENSIONS (mm)



SCOPE AND COMPATIBILITY

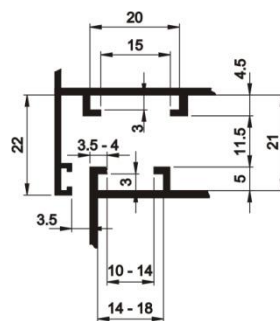

TEST	STANDARD	RESULT
Resistance to corrosion	UNE-EN 1670	Grade 4

MATERIALS	
Frame	Extruded aluminium
Screws	Stainless steel
Shaft	Stainless steel
Flange	Zamak
Sleeve	Polyamide

FINISHING TOUCHES AND SURFACE TREATMENTS						
WHITE	BLACK	RAL	SILVER	GOLD	BRONZE	INOX

PACKAGING
50 units with preassembled flanges in a 415x215x60 mm box. Eccentric sleeve available