

- FITTED DOUBLE-ACTION BOLT FOR FOLDING SYSTEMS.
- ASSEMBLABLE WITH THE HANDLE KNOB 215T.
- 10 mm SHAFT. FOR FOLDING SYSTEMS AND EXTERNAL OPENING SYSTEMS.

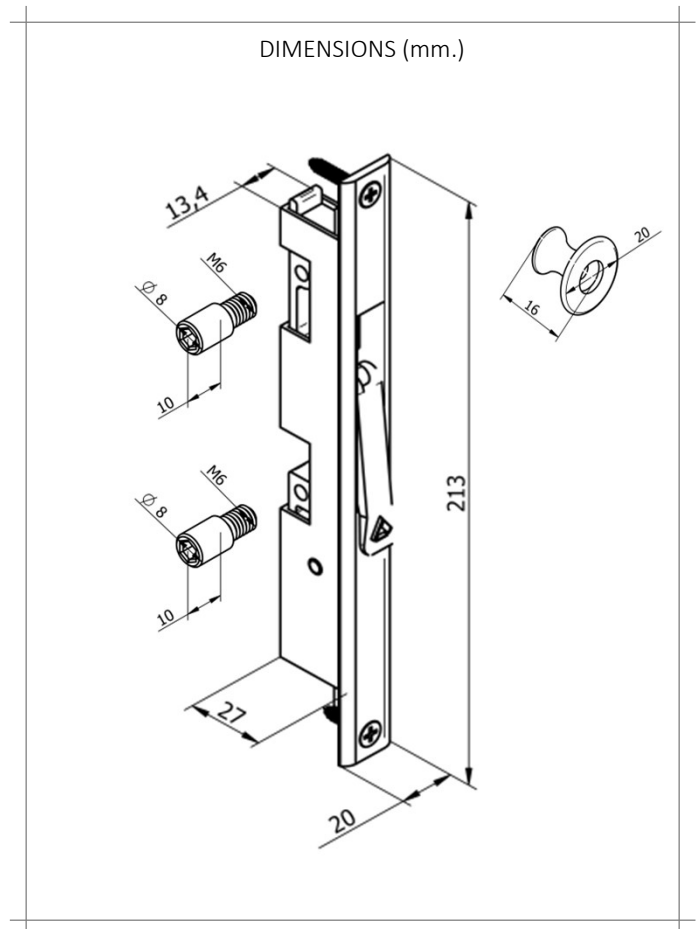

TEST	STANDARD	RESULT
Resistance to corrosion	UNE-EN 1670	Grade 4

MATERIALS	
Frame and slide	Extruded aluminium
Lever and sprocket	Polyamide
Spring	Stainless steel
Handle knob	Extruded aluminium
Screw L-10	Galvanized steel

**FINISHING TOUCHES AND SURFACE TREATMENTS**

WHITE    BLACK    RAL    SILVER    GOLD    BRONZE    INOX

**PACKAGING**

215 Bolt : 10 units  
 215 handle knob : 10 units  
 215 Screw set : 10 units  
 Handle knob and screw set sold separately.

- FOR FRENCH-OPENING AND EXTERNAL OPENING DOORS AND WINDOWS..
- REVERSIBLE: EASY CHANGE OF SIDE.
- MAXIMUM RESISTANCE TO CORROSION.

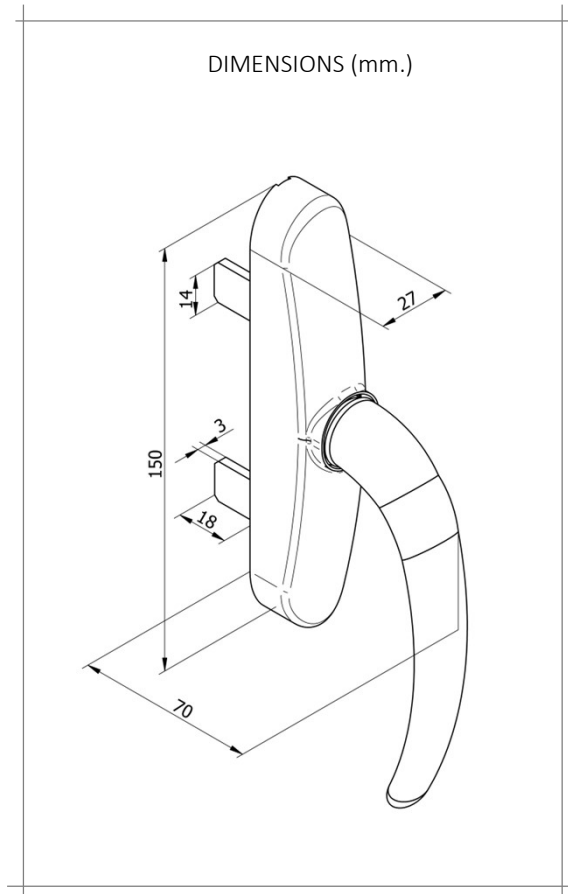

TEST	STANDARD	RESULT
Resistance to corrosion	UNE-EN 1670	Grade 4

MATERIALS	
Handle	Injected aluminium
Louver	Zamak
Frame	Zamak
Frame cover	Zamak
Basis	Polyamide
Screw	Stainless steel

**FINISHING TOUCHES AND SURFACE TREATMENTS**

WHITE    BLACK    RAL    SILVER    GOLD    BRONZE    INOX

**PACKAGING**

10 units packed in a 305x170x125mm box.

**6250: OUTSIDE OPENING KIT**

- ADAPTATOR FOR OUTSIDE OPENING ESPAGNOLETTE WITH 14X3 MM LOUVERS.
- ALUMINIUM FRAME, POLYAMIDE INSIDE, STEEL SCREWS.

6255000009: OUTSIDE OPENING KIT

6256180000: 18 MM SCREW

6256230000: 23 MM SCREW

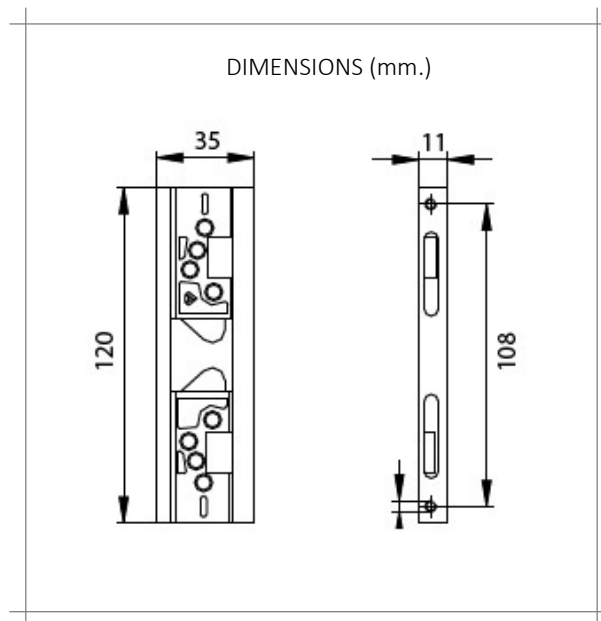
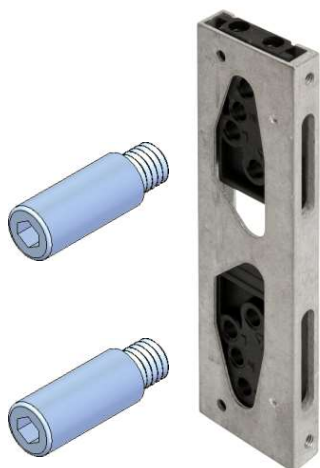

**6255: OUTSIDE OPENING KIT**

- ADAPTATOR FOR OUTSIDE OPENING ESPAGNOLETTE WITH 14X3 MM LOUVERS.
- FOR ANY PROFILE TYPE THANKS TO ITS 4 SCREW THREADS.
- ZAMAK ADAPTATOR, STEEL SCREWS, STAINLESS STEEL RETENTION SCREW.

6255T18000: OUTSIDE OPENING KIT WITH 18 mm SCREW.

6255T23000: OUTSIDE OPENING KIT WITH 23 mm SCREW

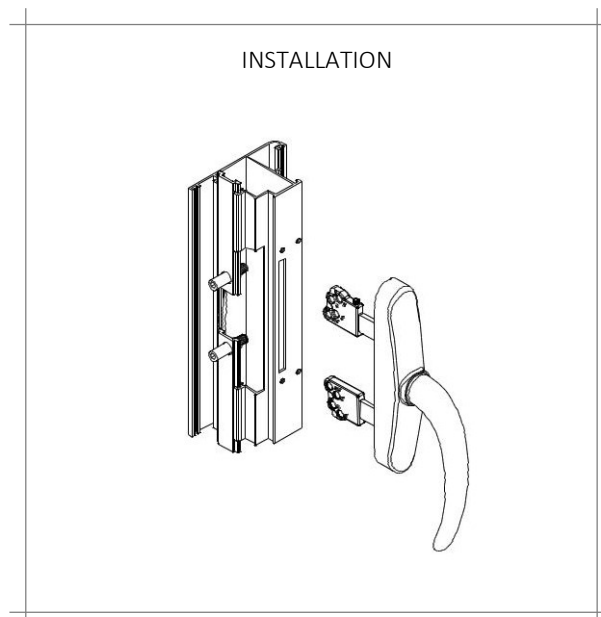
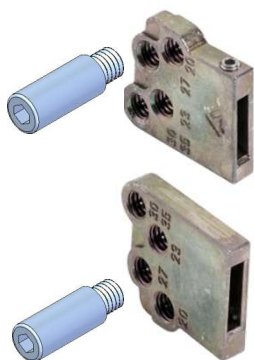

2027 : KEEPER FOR FOLDING SYSTEMS ON OPENING FRAME PROFILE

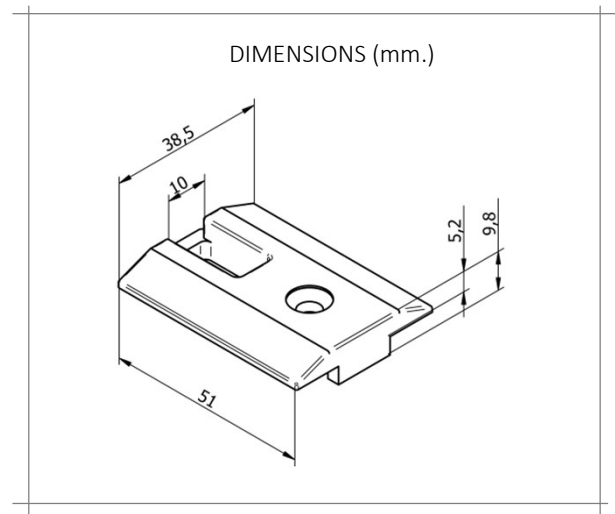

MATERIALS	
Frame	Polyamide
Screw and nut	Stainless steel
Flange	Stainless steel

PACKAGING
1 unit

2078/9 - LOCKING POINT 9mm. TO UPPER PROFILE AND KEEPER 2027  
 2078/11 - LOCKING POINT 11 mm TO 12 mm DOWN PROFILE  
 2078/14 - LOCKING POINT 14 mm TO 15mm BOTTOM FRAME PROFILE

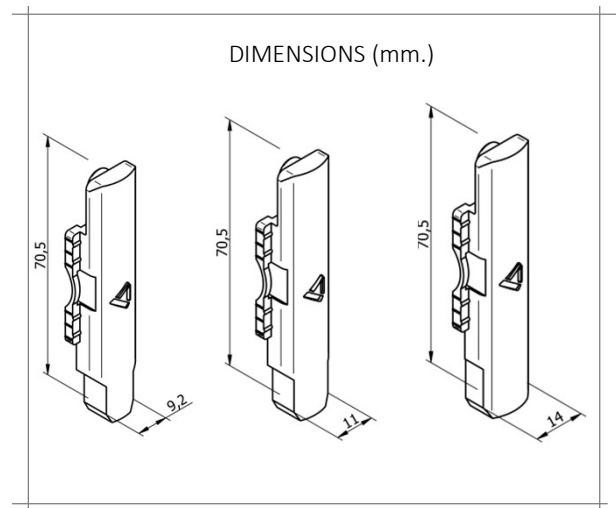

MATERIALS	
Locking point	Polyamide

PACKAGING
1 unit

**14000/SP00 – LOCKING KIT WITHOUT CASING**  
CLOSING SYSTEM FOR SLIDING SHUTTER.

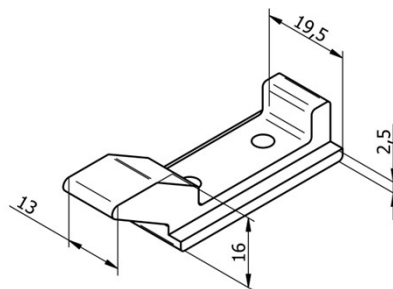

**14000/0000 – CLOSING KIT WITHOUT LOCK**  
CLOSING SYSTEM FOR SLIDING SHUTTER

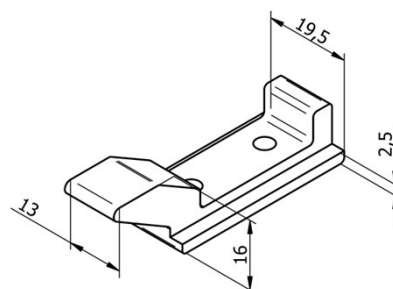

**MATERIALS**

Keepers	Extruded aluminium
Vis	Stainless Steel

**FINISHING TOUCHES AND SURFACE TREATMENTS**



BLACK

**PACKAGING**

1 unit

INDIVIDUAL HINGE FOR SHUTTERS

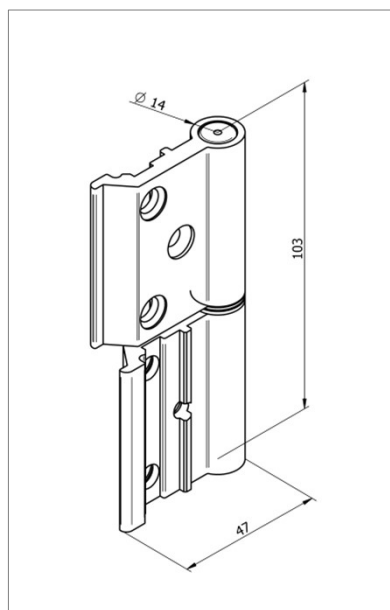

2075 TRIPLE HINGE FOR FOLDING SYSTEMS

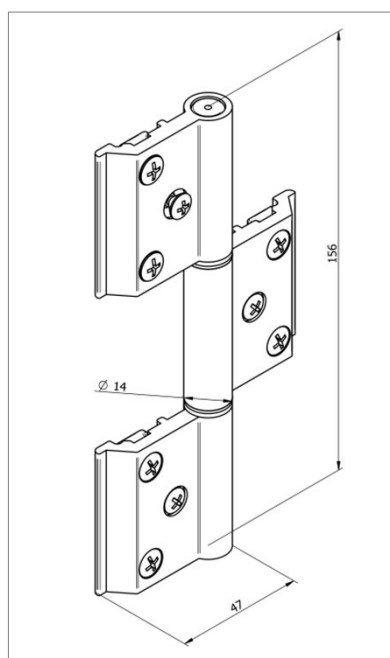

**MATERIALS**

Louvers	Extruded aluminium
Flanges	Zamak
Sleeve	Polyamide
Screws	Stainless Steel

**FINISHING TOUCHES AND SURFACE TREATMENTS**



**PACKAGING**

2075 : 50 units packed in a 330x190x70 mm box.  
2075 TRIPLE: 30 units packed in a 330x190x70 mm box.

**2077 LARGE HINGE**

- LARGE HINGE FOR SHUTTERS.
- ALLOWS THE LEAVES TO FOLD.

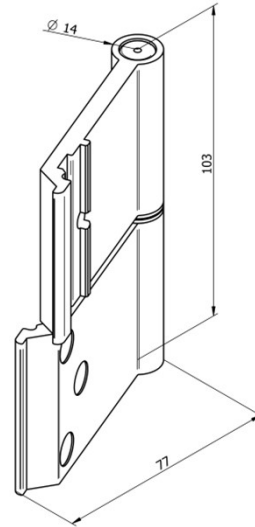

**2077 LARGE TRIPLE HINGE**

- LARGE HINGE FOR SHUTTERS.
- ALLOWS THE LEAVES TO FOLD.



**MATERIALS**

Louvers	Extruded aluminium
Flanges	Zamak
Sleeve	Polyamide
Screws	Stainless Steel

**FINISHING TOUCHES AND SURFACE TREATMENTS**



**PACKAGING**

2077: 50 units packed in a 390x190x110 box  
2077 TRIPLE: 30 units packed in a box

- DOUBLE HINGE SET FOR FOLDING SYSTEMS.
- VALID FOR 12 MM GUIDE AND 15 MM FIXED FRAME.
- MAXIMUM DIMENSIONS: 700X2800 MM.
- MAXIMUM LOAD : 50 KG PER LEAF.

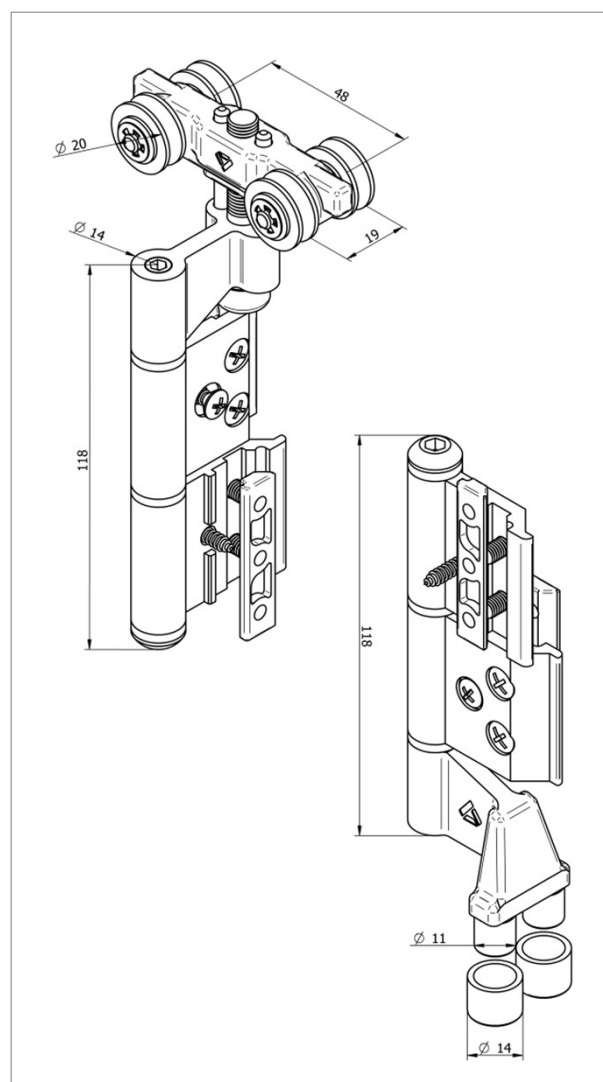

**MATERIALS**

Louvers	Extruded aluminium
Sleeve	PA6
Screws	Stainless Steel
Rollers	POM
Frame	Zamak

**FINISHING TOUCHES AND SURFACE TREATMENTS**



**PACKAGING**

25 sets in a 380x210x190 mm box



- ACCESSORY FOR FOLDING SYSTEMS WITH PAIR OF LEAVES.
- MINIMUM LEAF WIDTH 500 mm.
- MAXIMUM DIMENSIONS 700x2800 mm.
- MAXIMUM WEIGHT : 40 KG PER LEAF

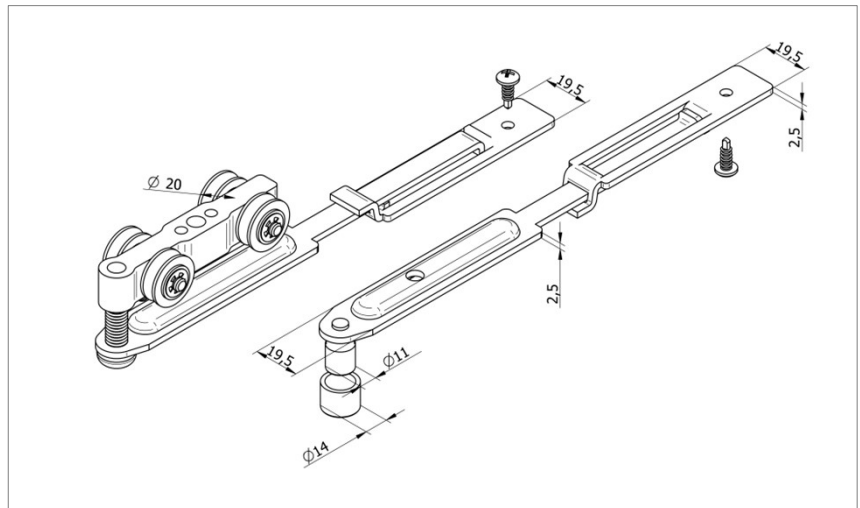

**MATERIALS**

Frame	Extruded aluminium
Rollers	Polyamide
Arm and basis	Stainless Steel
Shaft and screw	Stainless steel

**PACKAGING**

1 unit

**4020 – BOLT SET**

- ACCESSORY FOR LEAF GUIDING IN SHUTTER SYSTEMS.
- DIRECT FIXATION WITH SCREW.
- GUIDES THE LEAF IN THE PIVOT OF THE 12 MM LEAF PROFILE.

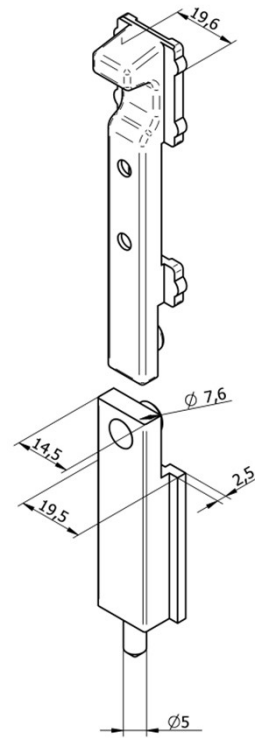

**MATERIALS**

Frame	Aluminium
Shaft	Stainless steel
Slider	Plastic

**4020 : LEAF BLOCKER**

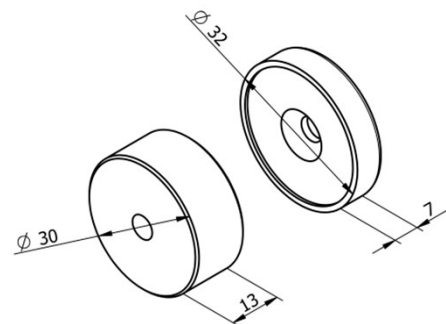

**MATERIALS**

Core	Iman
Frame	Galvanized steel
Cover	Galvanized Steel

**PACKAGING**

10 packed units

**4010 – ROLLER SET**

- UPPER ROLLER FOR SLIDING SHUTTERS.
- FOR EXTERNAL SWIVEL SYSTEMS.
- MAXIMUM LOAD : 40KG PER ROULETTE (80KG PER LEAF).

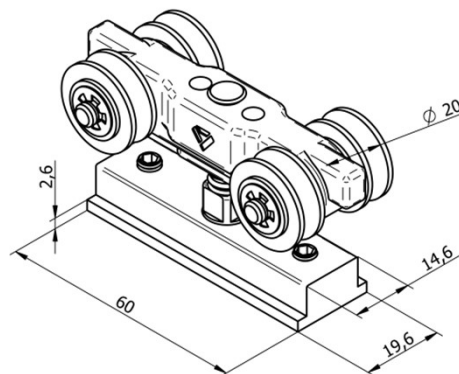

**MATERIALS**

Frame	Zamak
Rollers	POM
Screws	Stainless steel
Basis	Extruded aluminium

**PACKAGING**

1 unit

**4015 – REMOVABLE ROLLER SET**

- UPPER ROLLER FOR SLIDING SHUTTERS.
- FOR TABLE INSTALLATION
- MAXIMUM LOAD : 40KG PER ROULETTE (80KG PER LEAF).

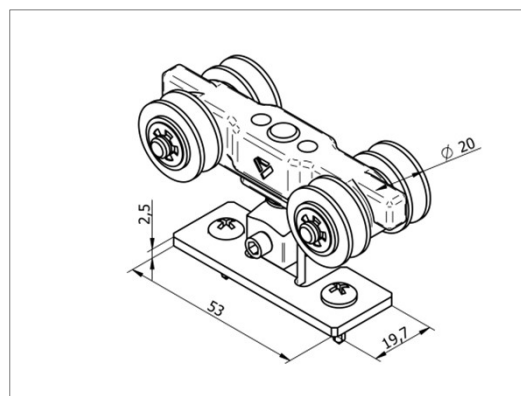

**MATERIALS**

Frame	Zamak
Rollers	POM
Screws	Stainless steel
Basis and central screw	Galvanized steel

**PACKAGING**

1 unit

**4010COTO00 – 4010 STOPPER SET**

- MULTIFUNCTIONAL ACCESSORY FOR SLIDING SHUTTER SYSTEM.
- WORKS AS A KEEPER THANKS TO THE LOCKING POINTS.
- WORKS AS A STOPPER AGAINST THE ROLLERS SO AS TO PREVENT THE LEAF FROM MOVING.
- « END OF TRAJECTORY CLIC » WITH THE LOCKING POINT 4010.

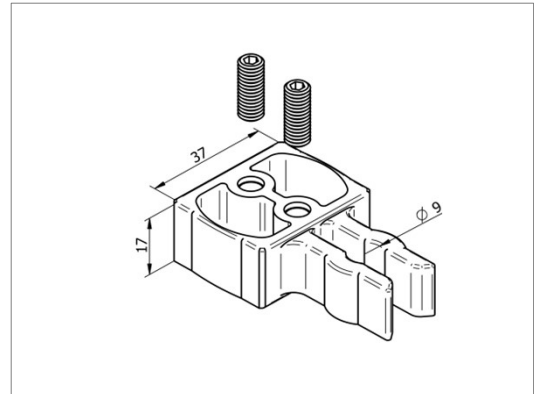

**MATERIALS**

Frame	Polyamide PA6
Screws	Stainless steel

**PACKAGING**

1 unit

**4010PLEN00 – 4010 TOP HUNG COUPLING HARDWARE**

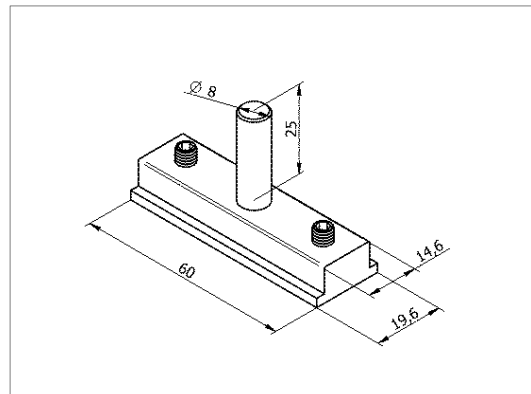

**MATERIALS**

Frame	Extruded aluminium
Shaft and screws	Stainless steel

**PACKAGING**

100 units in a bag

**4012 – SUPPORT SET 22-38**

- SUPPORT FOR LEAF GUIDING IN SLIDING SHUTTER SYSTEMS, WHICH REPLACES THE LOWER GUIDE
- ADJUSTABLE FROM 22 TO 38 MM.

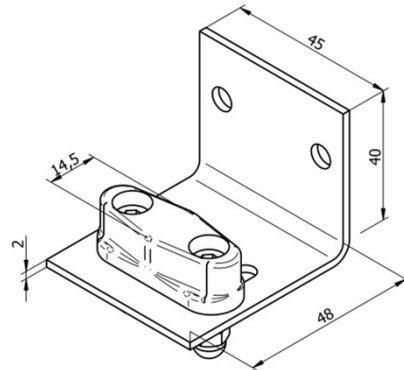
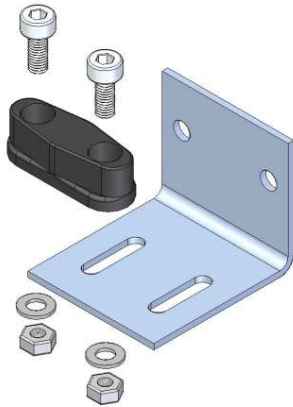
**4012 – SUPPORT SET 53-69**

- SUPPORT FOR LEAF GUIDING IN SLIDING SHUTTER SYSTEMS, WHICH REPLACES THE LOWER GUIDE
- ADJUSTABLE FROM 53 TO 69 MM.

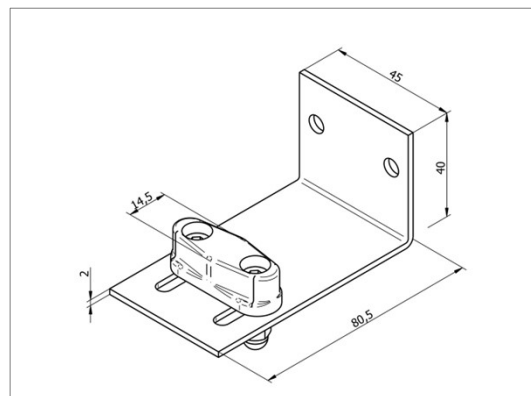
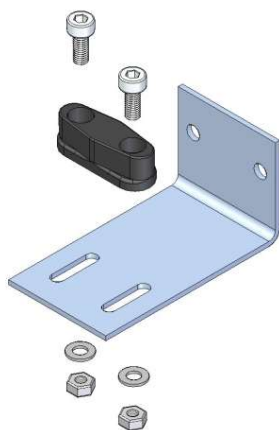
**MATERIALS**

Support and screws	Stainless steel (AISI-304)
Guide	Polyamide (PA6)

**PACKAGING**

30 support sets in a bag

**4013 – BOTTOM SLIDING DEVICE**

- ACCESSORY FOR LEAF GUIDING IN SLIDING SHUTTER SYSTEMS.
- DIRECT FIXATION WITH A SCREW IN THE LOWER PART OF THE LEAF FOR GUIDING IN THE LOWER 12 MM RAIL.

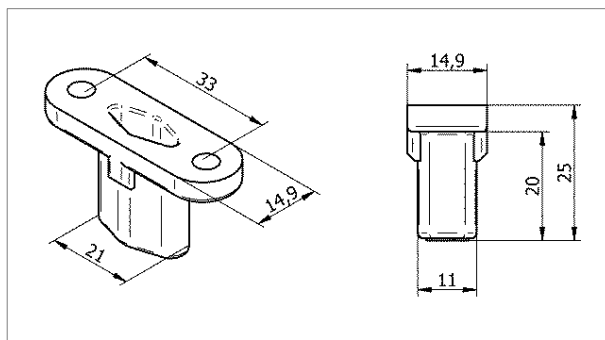

**MATERIALS**

Support Polyamide (PA6)

**PACKAGING**

50 units in a bag

**4014 – BOTTOM SLIDING SUPPORT**

- ACCESSORY FOR LEAF GUIDING IN SLIDING SHUTTER SYSTEMS.
- DIRECT FIXATION WITH A SCREW.
- GUIDES THE LEAF ACROSS THE PIVOT, 12 MM RAIL.

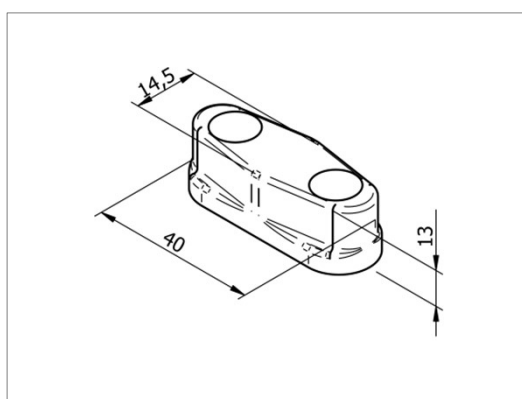

**MATERIALS**

Support Polyamide (PA6)

**PACKAGING**

50 units in a bag

- ACCESORIOS PARA CONTRAVENTANA CORREDERA.
- CARRO, TOPE ENGANCHE Y PLETINA FIJACIÓN SE VENDEN POR SEPARADO, SEGÚN LAS NECESIDADES DEL CLIENTE.
- CARGA MÁXIMA: 50 KG POR CARRO (100 KG POR HOJA)
- RODAMIENTOS DE AGUJAS AUTOLUBRICADOS.
- FUNCIÓN DE ENGANCHE INTEGRADA EN CARRO.



4016 CARRO

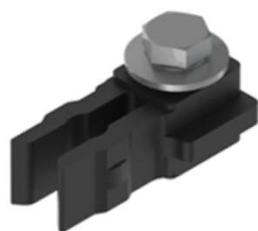
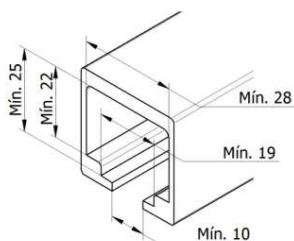

4016 TOPE ENGANCHE

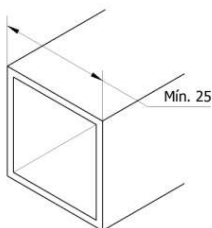

4016 PLETINA FIJACIÓN

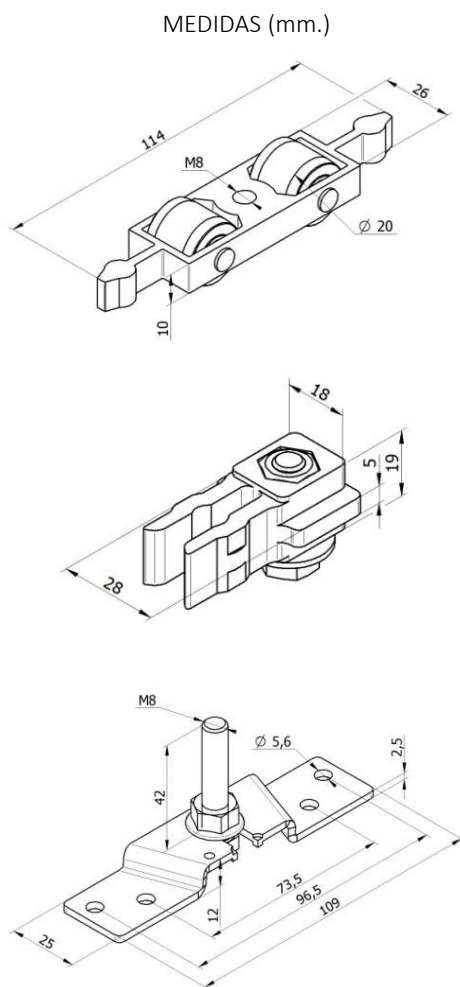

**MATERIALES**

Rueda	POM
Cuerpo carro	Aluminio
Chapa y eje	Inox
Tornillos	Inox
Pinza	PP

**PRESENTACIÓN**

Embalaje individual

ENSAYO	NORMA	RESULTADO
Resistencia a la corrosión	UNE-EN 1670	Grado 4
Durabilidad	INTERNO	100.000 ciclos
Carga	INTERNO	100 Kg.